

Rev 10/13

- Legend**
- Elevators
 - Restrooms
 - Stair
 - Escalator
 - Information / Security
Lost? Call 212 • 241 • 6068
or 46068 from a House Phone
 - All buildings are wheelchair accessible.
For Atran, please get directions.
 - 1 Faculty Practice
 - 2 Dubin Breast Center
 - 3 Kravis Children's Hospital
 - 4 Bookstore
 - 5 Chapel (1st and 2nd Floor)
 - 6 Cashier
 - 7 ATM Machine
 - 8 Plaza Café
 - 9 Martha Stewart Center for Living
 - 10 Emergency Room (Enter at Madison Ave.)
 - 11 Ruttenberg Treatment Center
 - 12 Mount Sinai Heart
 - 13 Goldwurm Auditorium
 - 14 Hatch Auditorium (2nd Floor)
 - 15 Stern Auditorium (2nd Floor)
 - 16 Patient Service Center
 - 17 Admissions/Pre-Testing/Surgical and Procedural Registration/Family Waiting Area (2nd Floor)
 - 17 Primary Care Associates
- Note: Gift Shop is on the 7th Floor of the Guggenheim Pavilion. Take West Elevators.

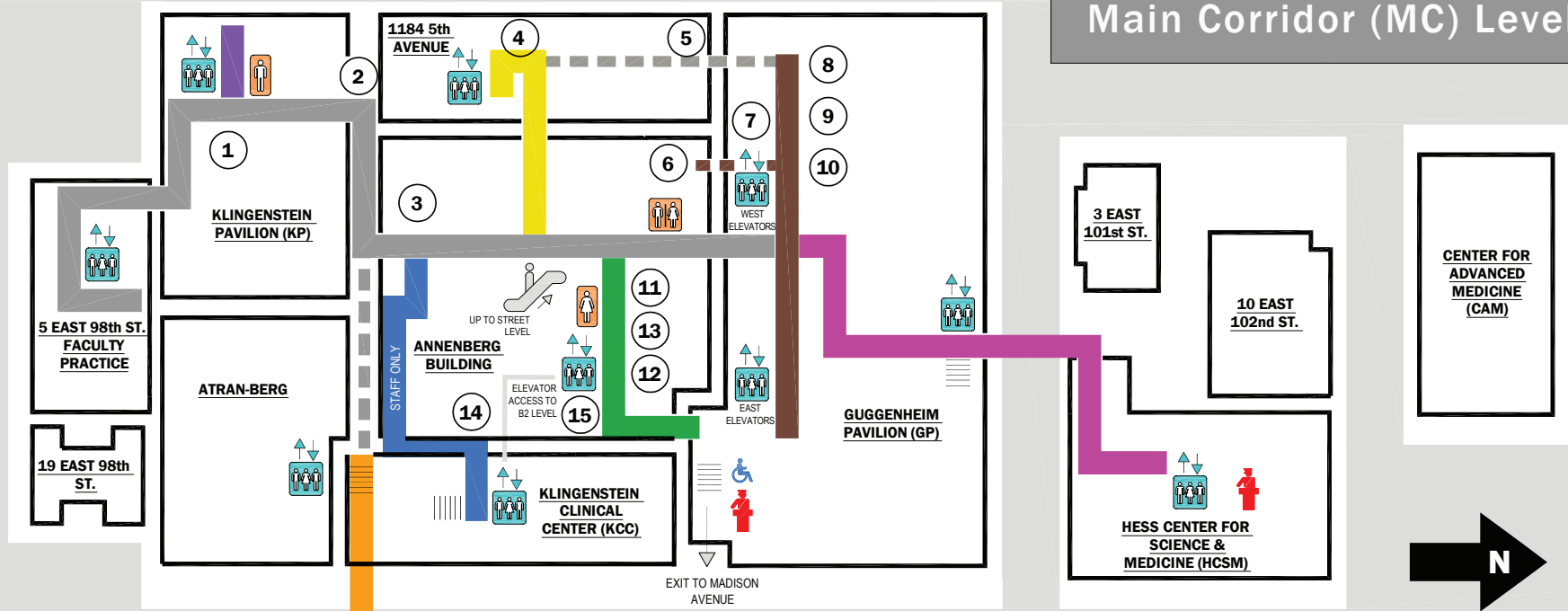

Main Corridor (MC) Level



ICAHN MEDICAL
INSTITUTE (IMI)



Rev 10/13

- | | |
|-----------------------------------|---|
| ① Radiology Associates | ⑨ Radiology Film Library |
| ② Radiology Associates Scheduling | ⑩ In-Patient MRI Suite |
| ③ Interventional Radiology | ⑪ Cashier (Check/Credit Card Only) |
| ④ Radiation Oncology | ⑫ Medicaid Office |
| ⑤ Pediatric Radiology | ⑬ Pharmacy (Employees Only) |
| ⑥ Main Radiology | ⑭ Kidney Center Dialysis |
| ⑦ Pulmonary Function Lab | ⑮ Medical Records
(Take Annenberg elevator down to B2 Level) |
| ⑧ Nuclear Medicine / PET | |



Mount
Sinai